

Location Map
Not to scale

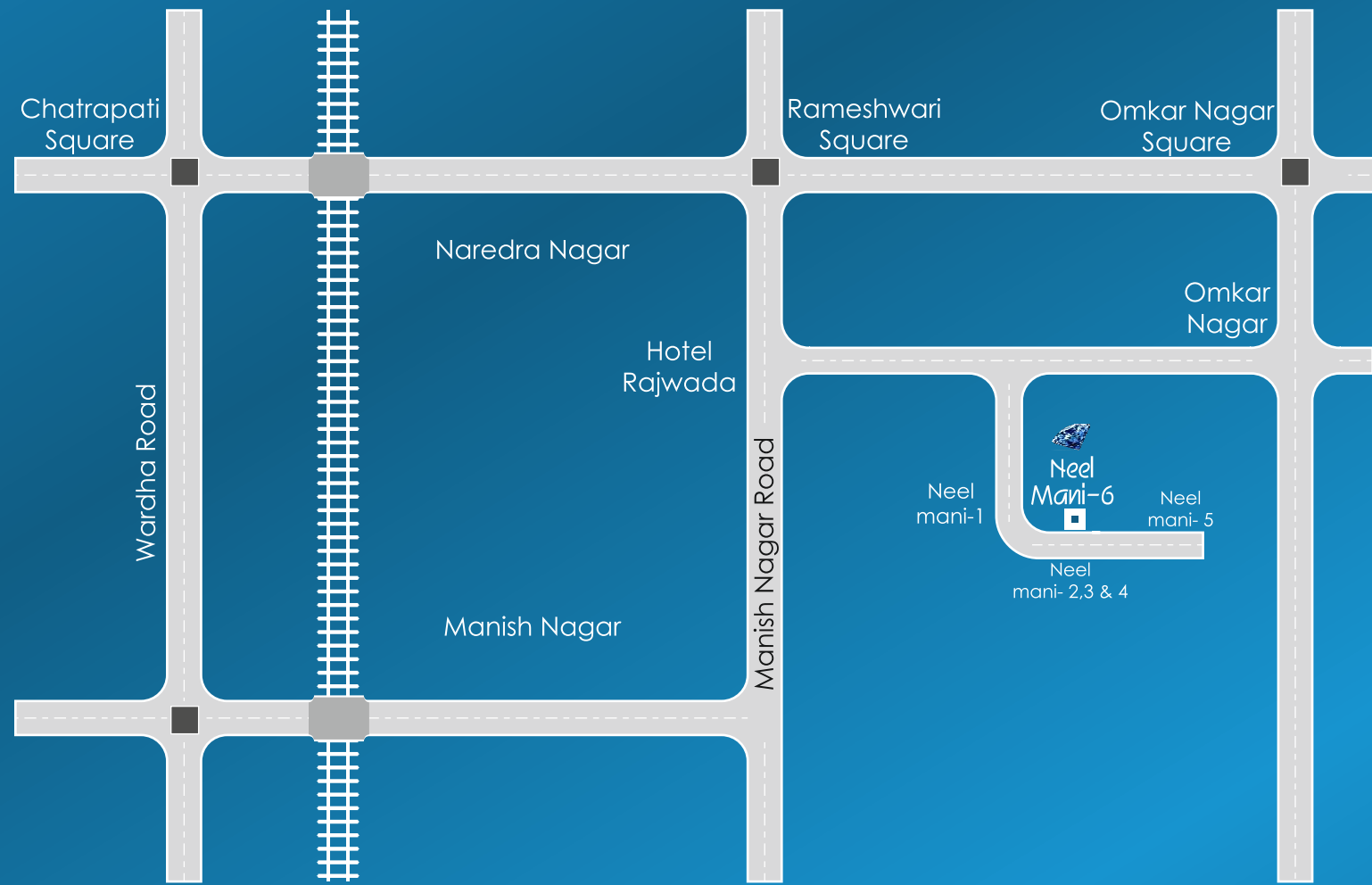

Site Address: Plot No. 24A & 25A, Rajashri Nagar, Nagpur.

A project By



Office: Savitri Vihar, Near Apna Bhandar, Somalwada,
Wardha Road Nagpur. Tel. 0712 2295518

Booking Contact

Sachin Mehar - 9960447888, 7378660558

Architects & Civil engineers
Sukhakarta Building Engineers
9822947996

Structural Designer
Er.Sudhesh Malode

Legal Advisor
Adv. Ritesh Mahindra

Design @ Helix design studio- 9730921314



Neel Mani-6

2 BHK luxurious Apartment



**LIVE AND REDEFINE THE LUXURIES
OF LIFE...**



ABOUT US

We are proud of our team, who are dedicated to craftsmanship, open communications and a pleasurable building experience 'Mehar Infrastructure' is a premier construction company in the Nagpur city providing our clients buildings of exceptional quality, character and value. We utilize technically sophisticated systems, unique human resources, high levels of organization, and strong teamwork.

We create a safe environment that fosters mutually beneficial relationships for all stakeholders based on respect, honesty and integrity.



Typical First & Third Floor Plan

Typical First & Third Floor ISOMETRIC View
Flat No.101/301

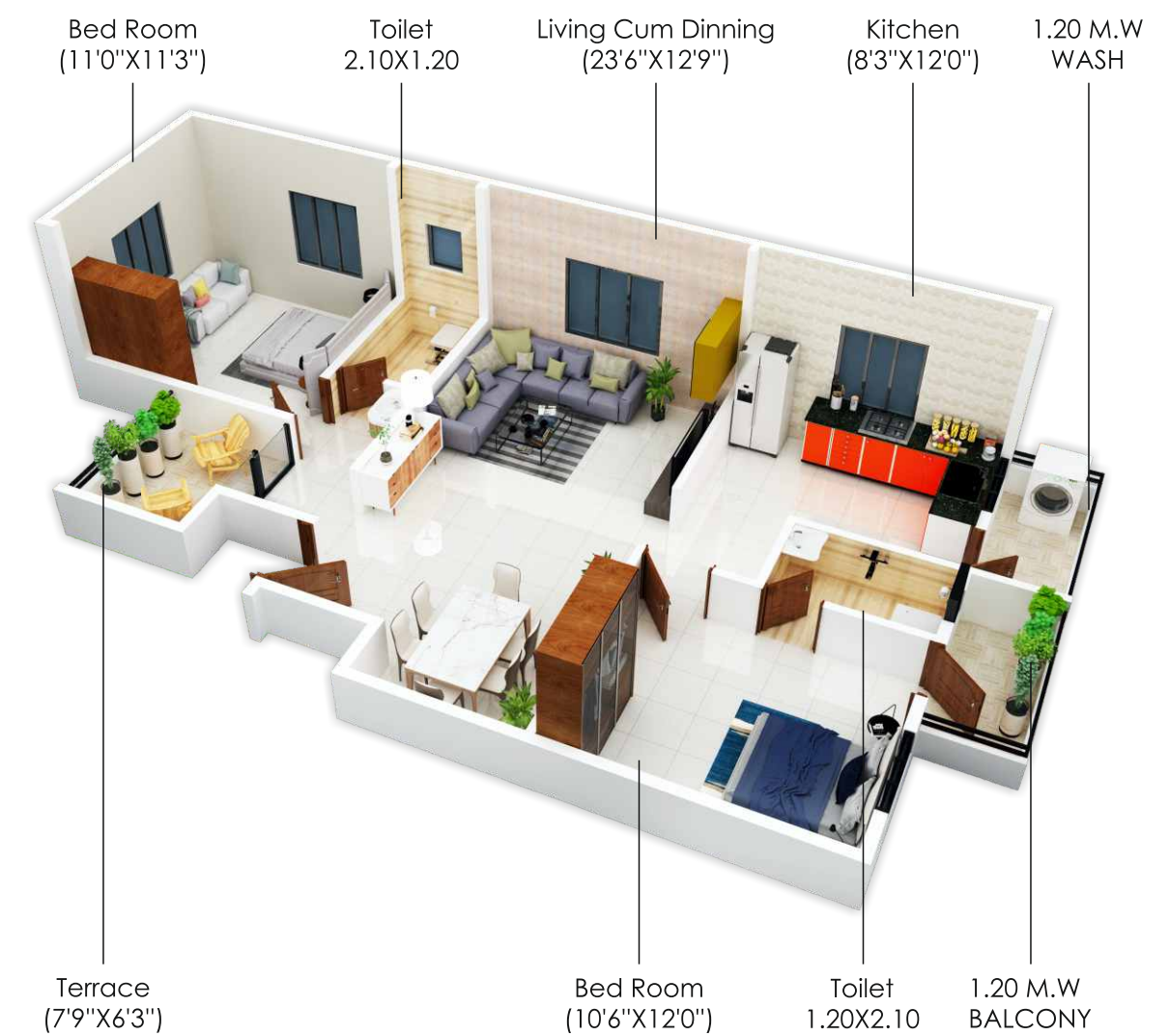

Ground Floor Plan



Unconditional opulence...
simply a way of your life at Neel Mani-6



Flat No.102/302



Typical Second & Fourth Floor Plan



NOTE Stamp Duty & Registration fees. M.S.E.B. Meter deposit, Electrical Meter charges, Transformer deposit, Water Meter & Connection Charges. Deposits & Expenses at actual to be paid extra in advance. G.S.T. or any such additional taxes will be charged extra. Changes in the specification & plan will cost extra. Possession of the flat will be given by the builder after clearance of all dues. Any Extra Work shall be charged separately before execution.



Specifications

STRUCTURE

- RCC framed structure

WALLS

- Internal : 4" (115mm) thick brick
- External : 6" (150mm) thick brick

ELECTRICAL

- Concealed electrical fitting with ISI Wire and modular switches
- Sufficient power outlet and light points provided

BED ROOM & LIVING ROOM

- Vitrified Tiles flooring
- Cable TV connections in Living Room
- AC Point Hall & Master Bedroom
- POP Hall & Master Bedroom

KITCHEN

- Granite top with S.S. Sink, Aqua guard point
- Modular Kitchen

PLUMBING

- ISI Mark Full CPVC, UPVC, SWR Pipe Fittings
- PVC Pipe for Soil pipe & Rain Water pipe

PAINTING

- Internal - Emulsion Paint with Full Putty
- External - Plastic Emulsion Paint

DOORS & WINDOWS

- Main Door - Metallic secure Door
- Other Door - Flush door & RCC frame
- Toilet Door - Waterproof door with RCC frame
- Windows - Aluminium Powder coated windows with M.S. safety grill



BATHROOM

- Antiskid Tiles flooring
- Washbasin
- Equivalent make fittings & premium sanitary ware
- Designer dado up to 7'
- Hot & Cold water connection



LIFT

- LIFT With ARD



PARKING

- Spacious covered car & 2 wheeler Parking